

Mit 24°-Innenkonus für Rohrenden
Bohrungsform W DIN 3861

With 24°-Cone for Tube Ends
Type of Port End W DIN 3861

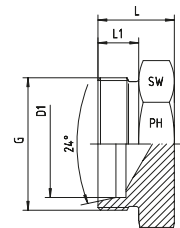

Reihe / Series L

Druck Pressure	Rohr A.D. Tube O.D.	Gewinde Thread	Ca. Maße Approx. Dimensions			Bemerkungen Notes	Bestellzeichen Order-Code	Brutto-Preis Gross-Price
PN	D1	G	L	L1	SW			Euro (€)
500	6	M 12 x 1,5	14,0	10,0	12		XROV-L-06	
500	8	M 14 x 1,5	15,0	10,0	14		XROV-L-08	
500	10	M 16 x 1,5	16,0	11,0	17		XROV-L-10	
400	12	M 18 x 1,5	17,0	11,0	19		XROV-L-12	
400	15	M 22 x 1,5	18,0	12,0	24		XROV-L-15	
400	18	M 26 x 1,5	19,0	12,0	27		XROV-L-18	
250	22	M 30 x 2	21,0	14,0	32		XROV-L-22	
250	28	M 36 x 2	22,0	14,0	41		XROV-L-28	
250	35	M 45 x 2	25,0	16,0	46		XROV-L-35	
250	42	M 52 x 2	27,0	16,0	55		XROV-L-42	

Reihe / Series S

Druck Pressure	Rohr A.D. Tube O.D.	Gewinde Thread	Ca. Maße Approx. Dimensions			Bemerkungen Notes	Bestellzeichen Order-Code	Brutto-Preis Gross-Price
PN	D1	G	L	L1	SW			Euro (€)
800	6	M 14 x 1,5	18,0	12,0	14		XROV-S-06	
800	8	M 16 x 1,5	20,0	12,0	17		XROV-S-08	
800	10	M 18 x 1,5	20,0	12,0	19		XROV-S-10	
630	12	M 20 x 1,5	22,0	12,0	22		XROV-S-12	
630	14	M 22 x 1,5	24,0	14,0	24		XROV-S-14	
630	16	M 24 x 1,5	24,0	14,0	27		XROV-S-16	
420	20	M 30 x 2	28,0	16,0	32		XROV-S-20	
420	25	M 36 x 2	32,0	18,0	41		XROV-S-25	
420	30	M 42 x 2	34,0	20,0	46		XROV-S-30	
420	38	M 52 x 2	39,0	22,0	55		XROV-S-38	