

DGWE - WINKEL - DREHVERSCHRAUBUNGEN

DGWE - ROTARY - COUPLINGS

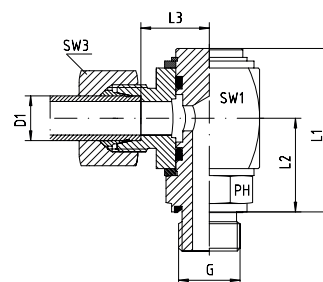

Winkel-Drehverschraubungen
 Einschraubgewinde G:
 Whitworth-Rohrgewinde - Zylindrisch
 Einschraubgewinde G: Metrisch - Zylindrisch
 Ausführung: Gehäuse aus Vierkantstahl
 Dichtungskombination:
 O-Ring + wd = FPM
 Stützring = PTFE



Elbow Rotary Couplings
 Thread G: BSP - Parallel
 Thread G: Metric - Parallel
 Construction: Bodies made from Steel Bar
 Sealing Combination:
 O-ring + wd = FPM
 Backing Ring = PTFE

Reihe / Series L

Druck Pressure	Rohr A.D. Tube O.D.		Ca. Maße Approx. Dimensions					Bestellzeichen Order-Code
	D1	G	L1	L2	L3	SW1	SW3	
250	6	1/8"	47,0	26,5	16,5	27	14	DGWE-L-06-G 1/8"-wd
250	6	1/4"	47,5	26,5	16,5	27	14	DGWE-L-06-G 1/4"-wd
250	6	3/8"	47,5	26,5	16,5	27	14	DGWE-L-06-G 3/8"-wd
250	8	1/4"	47,5	26,5	16,5	27	17	DGWE-L-08-G 1/4"-wd
250	8	3/8"	47,5	26,5	16,5	27	17	DGWE-L-08-G 3/8"-wd
250	10	1/4"	47,5	26,5	17,5	27	19	DGWE-L-10-G 1/4"-wd
250	10	3/8"	47,5	26,5	17,5	27	19	DGWE-L-10-G 3/8"-wd
250	12	1/4"	47,5	26,5	17,5	27	22	DGWE-L-12-G 1/4"-wd
250	12	3/8"	47,5	26,5	17,5	27	22	DGWE-L-12-G 3/8"-wd
250	12	1/2"	58,5	33,5	23,0	36	22	DGWE-L-12-G 1/2"-wd
250	15	1/2"	58,5	33,5	24,0	36	27	DGWE-L-15-G 1/2"-wd
160	18	1/2"	58,5	33,5	23,5	36	32	DGWE-L-18-G 1/2"-wd
160	22	3/4"	66,0	38,0	27,5	41	36	DGWE-L-22-G 3/4"-wd
100	28	1"	72,0	42,5	29,5	46	41	DGWE-L-28-G 1"-wd
100	35	1 1/4"	92,5	52,0	39,5	65	50	DGWE-L-35-G 1 1/4"-wd
100	42	1 1/2"	102,0	56,0	42,0	75	60	DGWE-L-42-G 1 1/2"-wd

Reihe / Series S

Druck Pressure	Rohr A.D. Tube O.D.		Ca. Maße Approx. Dimensions					Bestellzeichen Order-Code
	D1	G	L1	L2	L3	SW1	SW3	
400	6	1/4"	47,5	26,5	18,5	27	17	DGWE-S-06-G 1/4"-wd
400	6	3/8"	47,5	26,5	18,5	27	17	DGWE-S-06-G 3/8"-wd
400	8	1/4"	47,5	26,5	18,5	27	19	DGWE-S-08-G 1/4"-wd
400	8	3/8"	47,5	26,5	18,5	27	19	DGWE-S-08-G 3/8"-wd
400	10	1/4"	47,5	26,5	18,0	27	22	DGWE-S-10-G 1/4"-wd
400	10	3/8"	47,5	26,5	18,0	27	22	DGWE-S-10-G 3/8"-wd
400	12	3/8"	47,5	26,5	18,0	27	24	DGWE-S-12-G 3/8"-wd
400	14	1/2"	58,5	33,5	25,0	36	27	DGWE-S-14-G 1/2"-wd
400	16	1/2"	58,5	33,5	24,5	36	30	DGWE-S-16-G 1/2"-wd
250	20	3/4"	66,0	38,0	26,5	41	36	DGWE-S-20-G 3/4"-wd
250	25	1"	72,0	42,5	29,0	46	46	DGWE-S-25-G 1"-wd
250	30	1 1/4"	92,5	52,0	38,5	65	50	DGWE-S-30-G 1 1/4"-wd
250	38	1 1/2"	102,0	56,0	43,5	75	60	DGWE-S-38-G 1 1/2"-wd
400	16	M 22 x 1,5	58,5	33,5	24,5	36	30	DGWE-S-16-M 22x1,5-wd
250	20	M 27 x 2	66,0	38,0	26,5	41	36	DGWE-S-20-M 27x2-wd

