

SOCKET REPAIR CLAMP

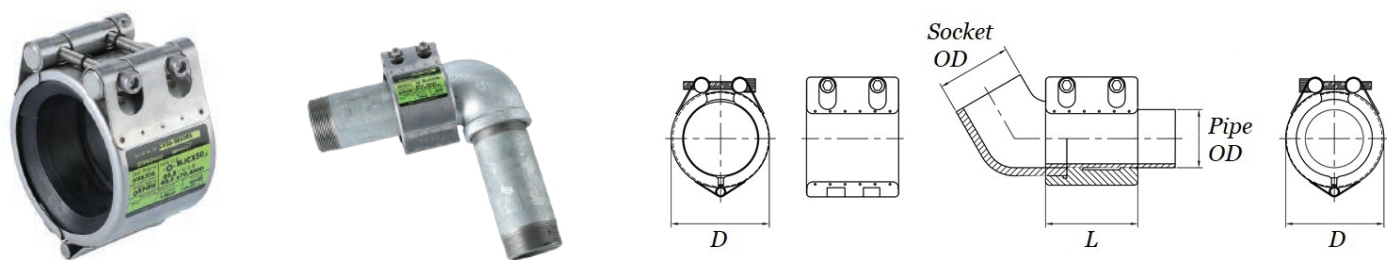

The connecting part of the socket method is half thick compared to the other part of a pipe. So, it is weak against vibration or other impacts. MJCX protects the weak part and also covers up damaged ones.

■ MJCX 20A~50A

Item No.	Pipe OD			Socket OD (mm)	D (mm)	Thickness (mm)	Pressure (bar)		MJCX		
									L (mm)	Torque (Nm)	Bolt (M)
	ND	inch	actual(mm)				Working	Max.			
4	20A	3/4	27.2	34.3	47.9	0.8	10	20	60	7	6
7	25A	1	34.0	42.3	55.9	0.8	10	20	60	7	6
11	32A	1 1/4	42.7	51.0	64.6	0.8	10	20	60	15	6
15	40A	1 1/2	48.6	57.2	70.8	0.8	10	20	60	15	6
20	50A	2	60.5	70.4	84.0	0.8	10	20	60	20	6

[Remarks]
D value varies depending on how much bolts are tightened.
Burst pressure ≥ working pressure x safety factor (2)

