

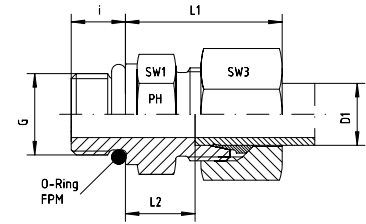

Gerade Einschraubverschraubungen
L-Reihe
Einschraubgewinde: UNF (ASA B 1.1 - 1960)
Abdichtung durch FPM Runddichtring (O-Ring) - SAE J 514
Achtung: Spezielle Gewindeausenkung erforderlich.
Andere Sprunggrößen auf Anfrage!



Male Stud Couplings
L-Series
Thread: UNF (ASA B 1.1 - 1960)
Sealing by FPM O-ring in Thread Undercut - SAE J 514
Note: A special part shape must be machined.
Other jump sizes on request!

Reihe / Series L

Druck Pressure	Rohr A.D. Tube O.D.	Gewinde Thread	Ca. Maße Approx. Dimensions			O-Ring O-ring	Bestellzeichen Order-Code	Brutto-Preis Gross-Price		
PN	D1	G	L1	L2	i	SW1	SW3	Euro (€)		
315	6	7/16"-20 UNF	23,5	9,0	9,2	17	14	8,92 x 1,83	GE-L-06-7/16"-UNF	
315	6	1/2"-20 UNF	28,0	10,0	9,2	17	14	10,52 x 1,83	GE-L-06-1/2"-UNF	
315	6	9/16"-18 UNF	27,5	10,0	10,0	19	14	11,90 x 1,98	GE-L-06-9/16"-UNF	
315	8	7/16"-20 UNF	25,0	10,0	9,2	17	17	8,92 x 1,83	GE-L-08-7/16"-UNF	
315	8	1/2"-20 UNF	25,0	10,0	9,2	17	17	10,52 x 1,83	GE-L-08-1/2"-UNF	
315	8	9/16"-18 UNF	25,0	10,0	10,0	19	17	11,90 x 1,98	GE-L-08-9/16"-UNF	
315	10	7/16"-20 UNF	26,0	11,0	9,2	17	19	8,92 x 1,83	GE-L-10-7/16"-UNF	
315	10	1/2"-20 UNF	26,0	11,0	9,2	17	19	10,52 x 1,83	GE-L-10-1/2"-UNF	
315	10	9/16"-18 UNF	26,0	11,0	10,0	19	19	11,90 x 1,98	GE-L-10-9/16"-UNF	
315	10	3/4"-16 UNF	30,5	13,0	11,2	24	19	16,36 x 2,20	GE-L-10-3/4"-UNF	
315	12	9/16"-18 UNF	26,0	12,5	10,0	19	22	11,90 x 1,98	GE-L-12-9/16"-UNF	
315	12	3/4"-16 UNF	27,0	12,5	11,2	24	22	16,36 x 2,20	GE-L-12-3/4"-UNF	
315	12	7/8"-14 UNF	27,5	13,5	12,7	27	22	19,18 x 2,46	GE-L-12-7/8"-UNF	
315	15	9/16"-18 UNF	29,0	14,0	10,0	24	27	11,90 x 1,98	GE-L-15-9/16"-UNF	
315	15	3/4"-16 UNF	29,0	14,0	11,2	24	27	16,36 x 2,20	GE-L-15-3/4"-UNF	
315	15	7/8"-14 UNF	29,0	14,0	12,7	27	27	19,18 x 2,46	GE-L-15-7/8"-UNF	
315	18	3/4"-16 UNF	31,0	14,5	11,2	27	32	16,36 x 2,20	GE-L-18-3/4"-UNF	
315	18	7/8"-14 UNF	31,0	14,5	12,7	27	32	19,18 x 2,46	GE-L-18-7/8"-UNF	
315	18	1 1/16"-12 UN	31,0	14,5	15,0	32	32	23,47 x 2,95	GE-L-18-1 1/16"-UN	
160	22	3/4"-16 UNF	33,0	16,5	11,2	32	36	16,36 x 2,20	GE-L-22-3/4"-UNF	
160	22	7/8"-14 UNF	33,0	16,5	12,7	32	36	19,18 x 2,46	GE-L-22-7/8"-UNF	
160	22	1 1/16"-12 UN	33,0	16,5	15,0	32	36	23,47 x 2,95	GE-L-22-1 1/16"-UN	
160	22	1 5/16"-12 UN	33,0	16,5	15,0	41	36	29,74 x 2,95	GE-L-22-1 5/16"-UN	
160	28	7/8"-14 UNF	34,0	17,5	12,7	41	41	19,18 x 2,46	GE-L-28-7/8"-UNF	
160	28	1 1/16"-12 UN	34,0	17,5	15,0	41	41	23,47 x 2,95	GE-L-28-1 1/16"-UN	
160	28	1 5/16"-12 UN	34,0	17,5	15,0	41	41	29,74 x 2,95	GE-L-28-1 5/16"-UN	
160	28	1 5/8"-12 UN	34,0	17,5	15,0	50	41	37,46 x 3,00	GE-L-28-1 5/8"-UN	
160	35	1 1/16"-12 UN	39,0	17,0	15,0	46	50	23,47 x 2,95	GE-L-35-1 1/16"-UN	
160	35	1 5/16"-12 UN	39,0	17,5	15,0	46	50	29,74 x 2,95	GE-L-35-1 5/16"-UN	
160	35	1 5/8"-12 UN	39,0	17,5	15,0	50	50	37,46 x 3,00	GE-L-35-1 5/8"-UN	
160	42	1 5/8"-12 UN	42,0	19,0	15,0	55	60	37,46 x 3,00	GE-L-42-1 5/8"-UN	
160	42	1 7/8"-12 UN	42,0	19,0	15,0	55	60	43,69 x 3,00	GE-L-42-1 7/8"-UN	

GE - GERADE - EINSCHRAUB - VERSCHRAUBUNGEN

GE - MALE - STUD - COUPLINGS

Gerade Einschraubverschraubungen
S-Reihe
Einschraubgewinde: UNF (ASA B 1.1 - 1960)
Abdichtung durch FPM Runddichtung (O-Ring) - SAE J 514
Achtung: Spezielle Gewindeausenkung erforderlich.
Andere Sprunggrößen auf Anfrage!

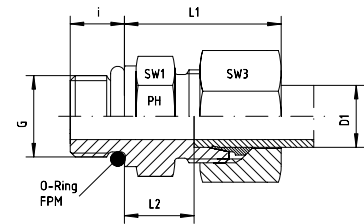

Male Stud Couplings
S-Series
Thread: UNF (ASA B 1.1 - 1960)
Sealing by FPM O-ring in Thread Undercut - SAE J 514
Note: A special part shape must be machined.
Other jump sizes on request!

Reihe / Series S

Druck Pressure	Rohr A.D. Tube O.D.	Gewinde Thread	Ca. Maße Approx. Dimensions					O-Ring O-ring	Bestellzeichen Order-Code	Brutto-Preis Gross-Price
PN	D1	G	L1	L2	i	SW1	SW3			Euro (€)
630	6	7/16"-20 UNF	28,0	13,0	9,2	17	17	8,92 x 1,83	GE-S-06-7/16"-UNF	
630	6	9/16"-18 UNF	29,0	13,0	10,0	19	17	11,90 x 1,98	GE-S-06-9/16"-UNF	
630	8	7/16"-20 UNF	30,0	15,0	9,2	17	19	8,92 x 1,83	GE-S-08-7/16"-UNF	
630	8	1/2"-20 UNF	30,0	15,0	9,2	17	19	10,52 x 1,83	GE-S-08-1/2"-UNF	
630	8	9/16"-18 UNF	30,0	13,0	10,0	19	19	11,90 x 1,98	GE-S-08-9/16"-UNF	
630	10	7/16"-20 UNF	41,0	13,5	9,2	19	22	8,92 x 1,83	GE-S-10-7/16"-UNF	
630	10	9/16"-18 UNF	31,0	15,5	10,0	19	22	11,90 x 1,98	GE-S-10-9/16"-UNF	
630	10	3/4"-16 UNF	31,0	15,0	11,2	24	22	16,36 x 2,20	GE-S-10-3/4"-UNF	
630	12	9/16"-18 UNF	33,5	14,5	10,0	22	24	11,90 x 1,98	GE-S-12-9/16"-UNF	
630	12	3/4"-16 UNF	33,5	17,5	11,2	24	24	16,36 x 2,20	GE-S-12-3/4"-UNF	
630	12	7/8"-14 UNF	32,5	14,8	12,7	27	24	19,18 x 2,46	GE-S-12-7/8"-UNF	
630	14	9/16"-18 UNF	37,0	19,0	10,0	24	27	11,90 x 1,98	GE-S-14-9/16"-UNF	
630	14	3/4"-16 UNF	37,0	19,0	11,2	24	27	16,36 x 2,20	GE-S-14-3/4"-UNF	
400	16	9/16"-18 UNF	51,0	19,5	10,0	27	30	11,90 x 1,98	GE-S-16-9/16"-UNF	
400	16	3/4"-16 UNF	37,0	18,5	11,2	27	27	16,36 x 2,20	GE-S-16-3/4"-UNF	
400	16	7/8"-14 UNF	33,5	15,5	14,0	30	27	19,18 x 2,46	GE-S-16-7/8"-UNF	
400	16	1 1/16"-12 UN	37,0	18,5	15,0	32	30	23,47 x 2,95	GE-S-16-1 1/16"-UN	
400	20	3/4"-16 UNF	45,0	20,5	11,2	32	36	16,36 x 2,20	GE-S-20-3/4"-UNF	
400	20	7/8"-14 UNF	46,5	20,5	12,7	32	36	19,18 x 2,46	GE-S-20-7/8"-UNF	
400	20	1 1/16"-12 UN	45,0	20,5	15,0	32	36	23,47 x 2,95	GE-S-20-1 1/16"-UN	
400	20	1 5/16"-12 UN	45,0	22,5	15,0	41	36	29,74 x 2,95	GE-S-20-1 5/16"-UN	
400	25	1 1/16"-12 UN	47,0	23,0	15,0	41	46	23,47 x 2,95	GE-S-25-1 1/16"-UN	
400	25	1 5/16"-12 UN	47,0	23,0	15,0	41	46	29,74 x 2,95	GE-S-25-1 5/16"-UN	
400	30	1 1/16"-12 UN	50,0	23,5	15,0	46	50	23,47 x 2,95	GE-S-30-1 1/16"-UN	
400	30	1 5/16"-12 UN	50,0	23,5	15,0	46	50	29,74 x 2,95	GE-S-30-1 5/16"-UN	
400	30	1 5/8"-12 UN	50,0	23,5	15,0	50	50	37,46 x 3,00	GE-S-30-1 5/8"-UN	
315	38	1 5/16"-12 UN	57,0	26,0	15,0	55	60	29,74 x 2,95	GE-S-38-1 5/16"-UN	
315	38	1 5/8"-12 UN	57,0	26,0	15,0	55	60	37,46 x 3,00	GE-S-38-1 5/8"-UN	
315	38	1 7/8"-12 UN	57,0	26,0	15,0	55	60	43,69 x 3,00	GE-S-38-1 7/8"-UN	