

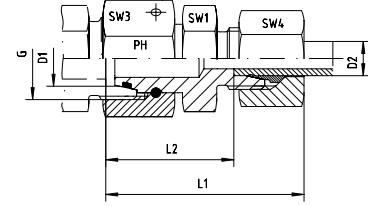

Mit Dichtkegel und O-Ring (DKO) - FPM  
Passend in Bohrungsform W DIN 3861  
Andere Abmessungen auf Anfrage!

With Taper and O-ring - FPM  
For Type of Port End W DIN 3861  
Other dimensions on request!



Reihe / Series L

Druck Pressure	Rohr A.D. Tube O.D.		Gewinde Thread	Ca. Maße Approx. Dimensions			Bemerkungen Notes			Bestellzeichen Order-Code
PN	D1	D2	G	L1	L2	SW1	SW3	SW4		
500	8	6	M 14 x 1,5	38,0	23,5	12	17	14		RED-DKOL-08/06
500	10	6	M 16 x 1,5	40,0	25,0	14	19	14		RED-DKOL-10/06
500	10	8	M 16 x 1,5	40,0	25,0	14	19	17		RED-DKOL-10/08
400	12	6	M 18 x 1,5	40,0	25,0	17	22	14		RED-DKOL-12/06
400	12	8	M 18 x 1,5	40,0	25,0	17	22	17		RED-DKOL-12/08
400	12	10	M 18 x 1,5	41,0	26,0	17	22	19		RED-DKOL-12/10
400	15	6	M 22 x 1,5	43,0	28,5	19	27	14		RED-DKOL-15/06
400	15	8	M 22 x 1,5	43,0	28,5	19	27	17		RED-DKOL-15/08
400	15	10	M 22 x 1,5	44,0	29,5	19	27	19		RED-DKOL-15/10
400	15	12	M 22 x 1,5	44,0	29,5	19	27	22		RED-DKOL-15/12
400	18	6	M 26 x 1,5	43,0	28,0	24	32	14		RED-DKOL-18/06
400	18	8	M 26 x 1,5	43,0	28,0	24	32	17		RED-DKOL-18/08
400	18	10	M 26 x 1,5	44,0	29,0	24	32	19		RED-DKOL-18/10
400	18	12	M 26 x 1,5	44,0	29,0	24	32	22		RED-DKOL-18/12
400	18	15	M 26 x 1,5	45,0	30,0	24	32	27		RED-DKOL-18/15
250	22	6	M 30 x 2	47,0	32,0	27	36	14		RED-DKOL-22/06
250	22	8	M 30 x 2	47,0	32,0	27	36	17		RED-DKOL-22/08
250	22	10	M 30 x 2	48,0	33,0	27	36	19		RED-DKOL-22/10
250	22	12	M 30 x 2	48,0	33,0	27	36	22		RED-DKOL-22/12
250	22	15	M 30 x 2	49,0	34,0	27	36	27		RED-DKOL-22/15
250	22	18	M 30 x 2	50,0	33,5	27	36	32		RED-DKOL-22/18
250	28	6	M 36 x 2	49,0	34,0	32	41	14		RED-DKOL-28/06
250	28	8	M 36 x 2	49,0	34,0	32	41	17		RED-DKOL-28/08
250	28	10	M 36 x 2	50,0	35,0	32	41	19		RED-DKOL-28/10
250	28	12	M 36 x 2	50,0	35,0	32	41	22		RED-DKOL-28/12
250	28	15	M 36 x 2	51,0	36,0	32	41	27		RED-DKOL-28/15
250	28	18	M 36 x 2	52,0	35,5	32	41	32		RED-DKOL-28/18
250	28	22	M 36 x 2	54,0	37,5	32	41	36		RED-DKOL-28/22
250	35	6	M 45 x 2	52,0	37,0	41	50	14		RED-DKOL-35/06
250	35	8	M 45 x 2	52,0	37,0	41	50	17		RED-DKOL-35/08
250	35	10	M 45 x 2	53,0	38,0	41	50	19		RED-DKOL-35/10
250	35	12	M 45 x 2	53,0	38,0	41	50	22		RED-DKOL-35/12
250	35	15	M 45 x 2	54,0	39,0	41	50	27		RED-DKOL-35/15
250	35	18	M 45 x 2	55,0	38,5	41	50	32		RED-DKOL-35/18
250	35	22	M 45 x 2	57,0	40,5	41	50	36		RED-DKOL-35/22
250	35	28	M 45 x 2	57,0	40,5	41	50	41		RED-DKOL-35/28
250	42	6	M 52 x 2	55,0	40,5	50	60	14		RED-DKOL-42/06
250	42	8	M 52 x 2	55,0	40,5	50	60	17		RED-DKOL-42/08
250	42	10	M 52 x 2	56,0	41,5	50	60	19		RED-DKOL-42/10
250	42	12	M 52 x 2	56,0	41,5	50	60	22		RED-DKOL-42/12
250	42	15	M 52 x 2	58,0	42,5	50	60	27		RED-DKOL-42/15
250	42	18	M 52 x 2	58,0	42,0	50	60	32		RED-DKOL-42/18
250	42	22	M 52 x 2	60,0	44,0	50	60	36		RED-DKOL-42/22
250	42	28	M 52 x 2	61,0	44,0	50	60	41		RED-DKOL-42/28
250	42	35	M 52 x 2	65,0	43,0	50	60	50		RED-DKOL-42/35

# RED - REDUZIER - VERSCHRAUBUNGEN

## RED - REDUCING - COUPLINGS

Mit Dichtkegel und O-Ring (DKO) - FPM  
Passend in Bohrungsform W DIN 3861  
Andere Abmessungen auf Anfrage!

With Taper and O-ring - FPM  
For Type of Port End W DIN 3861  
Other dimensions on request!

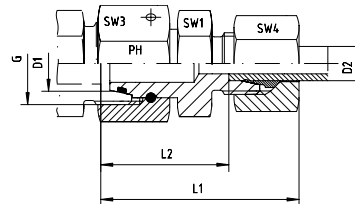

### Reihe / Series L

Druck Pressure	Rohr A.D. Tube O.D.		Gewinde Thread	Ca. Maße Approx. Dimensions			Bemerkungen Notes			Bestellzeichen Order-Code
PN	D1	D2	G	L1	L2	SW1	SW3	SW4		
500	8	6	M 14 x 1,5	38,0	23,5	12	17	14		RED-DKOL-08/06-SC
500	10	6	M 16 x 1,5	40,0	25,0	14	19	14		RED-DKOL-10/06-SC
500	10	8	M 16 x 1,5	40,0	25,0	14	19	17		RED-DKOL-10/08-SC
400	12	6	M 18 x 1,5	40,0	25,0	17	22	14		RED-DKOL-12/06-SC
400	12	8	M 18 x 1,5	40,0	25,0	17	22	17		RED-DKOL-12/08-SC
400	12	10	M 18 x 1,5	41,0	26,0	17	22	19		RED-DKOL-12/10-SC
400	15	6	M 22 x 1,5	43,0	28,5	19	27	14		RED-DKOL-15/06-SC
400	15	8	M 22 x 1,5	43,0	28,5	19	27	17		RED-DKOL-15/08-SC
400	15	10	M 22 x 1,5	44,0	29,5	19	27	19		RED-DKOL-15/10-SC
400	15	12	M 22 x 1,5	44,0	29,5	19	27	22		RED-DKOL-15/12-SC
400	18	6	M 26 x 1,5	43,0	28,0	24	32	14		RED-DKOL-18/06-SC
400	18	8	M 26 x 1,5	43,0	28,0	24	32	17		RED-DKOL-18/08-SC
400	18	10	M 26 x 1,5	44,0	29,0	24	32	19		RED-DKOL-18/10-SC
400	18	12	M 26 x 1,5	44,0	29,0	24	32	22		RED-DKOL-18/12-SC
400	18	15	M 26 x 1,5	45,0	30,0	24	32	27		RED-DKOL-18/15-SC
250	22	6	M 30 x 2	47,0	32,0	27	36	14		RED-DKOL-22/06-SC
250	22	8	M 30 x 2	47,0	32,0	27	36	17		RED-DKOL-22/08-SC
250	22	10	M 30 x 2	48,0	33,0	27	36	19		RED-DKOL-22/10-SC
250	22	12	M 30 x 2	48,0	33,0	27	36	22		RED-DKOL-22/12-SC
250	22	15	M 30 x 2	49,0	34,0	27	36	27		RED-DKOL-22/15-SC
250	22	18	M 30 x 2	50,0	33,5	27	36	32		RED-DKOL-22/18-SC
250	28	6	M 36 x 2	49,0	34,0	32	41	14		RED-DKOL-28/06-SC
250	28	8	M 36 x 2	49,0	34,0	32	41	17		RED-DKOL-28/08-SC
250	28	10	M 36 x 2	50,0	35,0	32	41	19		RED-DKOL-28/10-SC
250	28	12	M 36 x 2	50,0	35,0	32	41	22		RED-DKOL-28/12-SC
250	28	15	M 36 x 2	51,0	36,0	32	41	27		RED-DKOL-28/15-SC
250	28	18	M 36 x 2	52,0	35,5	32	41	32		RED-DKOL-28/18-SC
250	28	22	M 36 x 2	54,0	37,5	32	41	36		RED-DKOL-28/22-SC
250	35	6	M 45 x 2	52,0	37,0	41	50	14		RED-DKOL-35/06-SC
250	35	8	M 45 x 2	52,0	37,0	41	50	17		RED-DKOL-35/08-SC
250	35	10	M 45 x 2	53,0	38,0	41	50	19		RED-DKOL-35/10-SC
250	35	12	M 45 x 2	53,0	38,0	41	50	22		RED-DKOL-35/12-SC
250	35	15	M 45 x 2	54,0	39,0	41	50	27		RED-DKOL-35/15-SC
250	35	18	M 45 x 2	55,0	38,5	41	50	32		RED-DKOL-35/18-SC
250	35	22	M 45 x 2	57,0	40,5	41	50	36		RED-DKOL-35/22-SC
250	35	28	M 45 x 2	57,0	40,5	41	50	41		RED-DKOL-35/28-SC
250	42	6	M 52 x 2	55,0	40,5	50	60	14		RED-DKOL-42/06-SC
250	42	8	M 52 x 2	55,0	40,5	50	60	17		RED-DKOL-42/08-SC
250	42	10	M 52 x 2	56,0	41,5	50	60	19		RED-DKOL-42/10-SC
250	42	12	M 52 x 2	56,0	41,5	50	60	22		RED-DKOL-42/12-SC
250	42	15	M 52 x 2	58,0	42,5	50	60	27		RED-DKOL-42/15-SC
250	42	18	M 52 x 2	58,0	42,0	50	60	32		RED-DKOL-42/18-SC
250	42	22	M 52 x 2	60,0	44,0	50	60	36		RED-DKOL-42/22-SC
250	42	28	M 52 x 2	61,0	44,0	50	60	41		RED-DKOL-42/28-SC
250	42	35	M 52 x 2	65,0	43,0	50	60	50		RED-DKOL-42/35-SC

# RED - REDUZIER - VERSCHRAUBUNGEN

RED - REDUCING - COUPLINGS



Mit Dichtkegel und O-Ring (DKO) - FPM  
Passend in Bohrungsform W DIN 3861  
Andere Abmessungen auf Anfrage!

With Taper and O-ring - FPM  
For Type of Port End W DIN 3861  
Other dimensions on request!

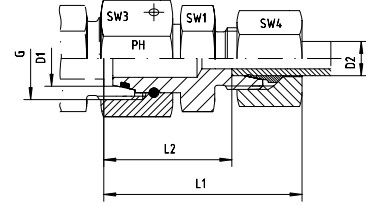

## Reihe / Series S

Druck Pressure	Rohr A.D. Tube O.D.		Gewinde Thread	Ca. Maße Approx. Dimensions			Bemerkungen Notes			Bestellzeichen Order-Code
PN	D1	D2	G	L1	L2	SW1	SW3	SW4		
800	8	6	M 16 x 1,5	42,0	27,0	14	19	17		RED-DKOS-08/06
800	10	6	M 18 x 1,5	42,0	27,5	17	22	17		RED-DKOS-10/06
800	10	8	M 18 x 1,5	42,0	27,5	17	22	19		RED-DKOS-10/08
630	12	6	M 20 x 1,5	44,0	29,0	17	24	17		RED-DKOS-12/06
630	12	8	M 20 x 1,5	44,0	29,0	17	24	19		RED-DKOS-12/08
630	12	10	M 20 x 1,5	46,0	29,5	19	24	22		RED-DKOS-12/10
630	14	6	M 22 x 1,5	46,0	31,5	19	27	17		RED-DKOS-14/06
630	14	8	M 22 x 1,5	46,0	31,5	19	27	19		RED-DKOS-14/08
630	14	10	M 22 x 1,5	47,0	31,0	19	27	22		RED-DKOS-14/10
630	14	12	M 22 x 1,5	47,0	31,0	22	27	24		RED-DKOS-14/12
630	16	6	M 24 x 1,5	47,0	32,0	22	30	17		RED-DKOS-16/06
630	16	8	M 24 x 1,5	47,0	32,0	22	30	19		RED-DKOS-16/08
630	16	10	M 24 x 1,5	48,0	31,5	22	30	22		RED-DKOS-16/10
630	16	12	M 24 x 1,5	48,0	31,5	22	30	24		RED-DKOS-16/12
630	16	14	M 24 x 1,5	51,0	33,0	22	30	27		RED-DKOS-16/14
420	20	6	M 30 x 2	51,0	36,0	27	36	17		RED-DKOS-20/06
420	20	8	M 30 x 2	51,0	36,0	27	36	19		RED-DKOS-20/08
420	20	10	M 30 x 2	52,0	35,5	27	36	22		RED-DKOS-20/10
420	20	12	M 30 x 2	52,0	35,5	27	36	24		RED-DKOS-20/12
420	20	14	M 30 x 2	55,0	37,0	27	36	27		RED-DKOS-20/14
420	20	16	M 30 x 2	55,0	36,5	27	36	30		RED-DKOS-20/16
420	25	6	M 36 x 2	53,0	38,5	32	41	17		RED-DKOS-25/06
420	25	8	M 36 x 2	53,0	38,5	32	41	19		RED-DKOS-25/08
420	25	10	M 36 x 2	54,0	38,0	32	41	22		RED-DKOS-25/10
420	25	12	M 36 x 2	54,0	38,0	32	41	24		RED-DKOS-25/12
420	25	14	M 36 x 2	57,0	39,5	32	41	27		RED-DKOS-25/14
420	25	16	M 36 x 2	57,0	39,0	32	41	30		RED-DKOS-25/16
420	25	20	M 36 x 2	61,0	39,0	32	41	36		RED-DKOS-25/20
420	30	6	M 42 x 2	59,0	44,0	41	50	17		RED-DKOS-30/06
420	30	8	M 42 x 2	59,0	44,0	41	50	19		RED-DKOS-30/08
420	30	10	M 42 x 2	60,0	43,5	41	50	22		RED-DKOS-30/10
420	30	12	M 42 x 2	60,0	43,5	41	50	24		RED-DKOS-30/12
420	30	14	M 42 x 2	63,0	45,0	41	50	27		RED-DKOS-30/14
420	30	16	M 42 x 2	63,0	44,5	41	50	30		RED-DKOS-30/16
420	30	20	M 42 x 2	66,0	44,5	41	50	36		RED-DKOS-30/20
420	30	25	M 42 x 2	69,0	45,0	41	50	46		RED-DKOS-30/25
420	38	6	M 52 x 2	63,0	47,0	50	60	17		RED-DKOS-38/06
420	38	8	M 52 x 2	63,0	47,0	50	60	19		RED-DKOS-38/08
420	38	10	M 52 x 2	63,0	47,0	50	60	22		RED-DKOS-38/10
420	38	12	M 52 x 2	63,0	47,0	50	60	24		RED-DKOS-38/12
420	38	14	M 52 x 2	66,0	48,5	50	60	27		RED-DKOS-38/14
420	38	16	M 52 x 2	66,0	48,0	50	60	30		RED-DKOS-38/16
420	38	20	M 52 x 2	70,0	48,0	50	60	36		RED-DKOS-38/20
420	38	25	M 52 x 2	73,0	48,5	50	60	46		RED-DKOS-38/25
420	38	30	M 52 x 2	76,0	49,0	50	60	50		RED-DKOS-38/30



Mit Dichtkegel und O-Ring (DKO) - FPM  
Passend in Bohrungsform W DIN 3861  
Andere Abmessungen auf Anfrage!

With Taper and O-ring - FPM  
For Type of Port End W DIN 3861  
Other dimensions on request!

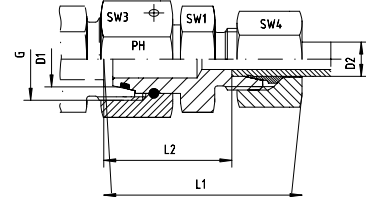

Reihe / Series S

Druck Pressure	Rohr A.D. Tube O.D.		Gewinde Thread	Ca. Maße Approx. Dimensions			Bemerkungen Notes			Bestellzeichen Order-Code
PN	D1	D2	G	L1	L2	SW1	SW3	SW4		
800	8	6	M 16 x 1,5	42,0	27,0	14	19	17		RED-DKOS-08/06-SC
800	10	6	M 18 x 1,5	42,0	27,5	17	22	17		RED-DKOS-10/06-SC
800	10	8	M 18 x 1,5	42,0	27,5	17	22	19		RED-DKOS-10/08-SC
630	12	6	M 20 x 1,5	44,0	29,0	17	24	17		RED-DKOS-12/06-SC
630	12	8	M 20 x 1,5	44,0	29,0	17	24	19		RED-DKOS-12/08-SC
630	12	10	M 20 x 1,5	46,0	29,5	19	24	22		RED-DKOS-12/10-SC
630	14	6	M 22 x 1,5	46,0	31,5	19	27	17		RED-DKOS-14/06-SC
630	14	8	M 22 x 1,5	46,0	31,5	19	27	19		RED-DKOS-14/08-SC
630	14	10	M 22 x 1,5	47,0	31,0	19	27	22		RED-DKOS-14/10-SC
630	14	12	M 22 x 1,5	47,0	31,0	22	27	24		RED-DKOS-14/12-SC
630	16	6	M 24 x 1,5	47,0	32,0	22	30	17		RED-DKOS-16/06-SC
630	16	8	M 24 x 1,5	47,0	32,0	22	30	19		RED-DKOS-16/08-SC
630	16	10	M 24 x 1,5	48,0	31,5	22	30	22		RED-DKOS-16/10-SC
630	16	12	M 24 x 1,5	48,0	31,5	22	30	24		RED-DKOS-16/12-SC
630	16	14	M 24 x 1,5	51,0	33,0	22	30	27		RED-DKOS-16/14-SC
420	20	6	M 30 x 2	51,0	36,0	27	36	17		RED-DKOS-20/06-SC
420	20	8	M 30 x 2	51,0	36,0	27	36	19		RED-DKOS-20/08-SC
420	20	10	M 30 x 2	52,0	35,5	27	36	22		RED-DKOS-20/10-SC
420	20	12	M 30 x 2	52,0	35,5	27	36	24		RED-DKOS-20/12-SC
420	20	14	M 30 x 2	55,0	37,0	27	36	27		RED-DKOS-20/14-SC
420	20	16	M 30 x 2	55,0	36,5	27	36	30		RED-DKOS-20/16-SC
420	25	6	M 36 x 2	53,0	38,5	32	41	17		RED-DKOS-25/06-SC
420	25	8	M 36 x 2	53,0	38,5	32	41	19		RED-DKOS-25/08-SC
420	25	10	M 36 x 2	54,0	38,0	32	41	22		RED-DKOS-25/10-SC
420	25	12	M 36 x 2	54,0	38,0	32	41	24		RED-DKOS-25/12-SC
420	25	14	M 36 x 2	57,0	39,5	32	41	27		RED-DKOS-25/14-SC
420	25	16	M 36 x 2	57,0	39,0	32	41	30		RED-DKOS-25/16-SC
420	25	20	M 36 x 2	61,0	39,0	32	41	36		RED-DKOS-25/20-SC
420	30	6	M 42 x 2	59,0	44,0	41	50	17		RED-DKOS-30/06-SC
420	30	8	M 42 x 2	59,0	44,0	41	50	19		RED-DKOS-30/08-SC
420	30	10	M 42 x 2	60,0	43,5	41	50	22		RED-DKOS-30/10-SC
420	30	12	M 42 x 2	60,0	43,5	41	50	24		RED-DKOS-30/12-SC
420	30	14	M 42 x 2	63,0	45,0	41	50	27		RED-DKOS-30/14-SC
420	30	16	M 42 x 2	63,0	44,5	41	50	30		RED-DKOS-30/16-SC
420	30	20	M 42 x 2	66,0	44,5	41	50	36		RED-DKOS-30/20-SC
420	30	25	M 42 x 2	69,0	45,0	41	50	46		RED-DKOS-30/25-SC
420	38	6	M 52 x 2	63,0	47,0	50	60	17		RED-DKOS-38/06-SC
420	38	8	M 52 x 2	63,0	47,0	50	60	19		RED-DKOS-38/08-SC
420	38	10	M 52 x 2	63,0	47,0	50	60	22		RED-DKOS-38/10-SC
420	38	12	M 52 x 2	63,0	47,0	50	60	24		RED-DKOS-38/12-SC
420	38	14	M 52 x 2	66,0	48,5	50	60	27		RED-DKOS-38/14-SC
420	38	16	M 52 x 2	66,0	48,0	50	60	30		RED-DKOS-38/16-SC
420	38	20	M 52 x 2	70,0	48,0	50	60	36		RED-DKOS-38/20-SC
420	38	25	M 52 x 2	73,0	48,5	50	60	46		RED-DKOS-38/25-SC
420	38	30	M 52 x 2	76,0	49,0	50	60	50		RED-DKOS-38/30-SC