

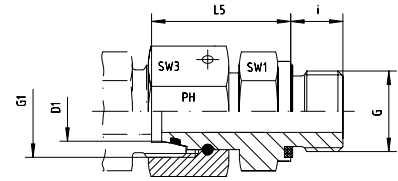

Mit Dichtkegel und O-Ring - FPM
Passend in Bohrungsform W DIN 3861
Einschraubgewinde:
Whitworth-Rohrgewinde - Zylindrisch
wd = Abdichtung durch Profildichtung - FPM

With Taper and O-ring - FPM
For Type of Port End W DIN 3861
Thread: BSP - Parallel
wd = Sealing by an Elastomer Profiled Ring - FPM



Reihe / Series S

Druck Pressure	Rohr A.D. Tube O.D.	Gewinde Thread	Ca. Maße Approx. Dimensions					Bestellzeichen Order-Code	Brutto-Preis Gross-Price
PN	D1	G	G1	L5	i	SW1	SW3		Euro (€)
800	6	G 1/4"	M 14 x 1,5	27,0	12,0	19	17	EGE-DKOS-06-G 1/4"-wd	
800	8	G 1/4"	M 16 x 1,5	29,5	12,0	19	19	EGE-DKOS-08-G 1/4"-wd	
800	8	G 3/8"	M 16 x 1,5	29,5	12,0	22	19	EGE-DKOS-08-G 3/8"-wd	
800	10	G 3/8"	M 18 x 1,5	32,0	12,0	22	22	EGE-DKOS-10-G 3/8"-wd	
800	10	G 1/4"	M 18 x 1,5	27,5	12,0	19	22	EGE-DKOS-10-G 1/4"-wd	
630	10	G 1/2"	M 18 x 1,5	32,0	14,0	27	22	EGE-DKOS-10-G 1/2"-wd	
630	12	G 1/4"	M 20 x 1,5	42,0	12,0	19	24	EGE-DKOS-12-G 1/4"-wd	
630	12	G 3/8"	M 20 x 1,5	34,0	12,0	22	24	EGE-DKOS-12-G 3/8"-wd	
630	12	G 1/2"	M 20 x 1,5	34,5	14,0	27	24	EGE-DKOS-12-G 1/2"-wd	
630	14	G 1/2"	M 22 x 1,5	36,5	14,0	27	27	EGE-DKOS-14-G 1/2"-wd	
630	16	G 3/8"	M 24 x 1,5	37,0	12,0	24	30	EGE-DKOS-16-G 3/8"-wd	
630	16	G 1/2"	M 24 x 1,5	37,0	14,0	27	30	EGE-DKOS-16-G 1/2"-wd	
420	16	G 3/4"	M 24 x 1,5	39,0	16,0	32	30	EGE-DKOS-16-G 3/4"-wd	
420	20	G 1/2"	M 30 x 2	38,0	14,0	27	36	EGE-DKOS-20-G 1/2"-wd	
420	20	G 3/4"	M 30 x 2	43,0	16,0	32	36	EGE-DKOS-20-G 3/4"-wd	
420	20	G 1"	M 30 x 2	55,0	18,0	41	36	EGE-DKOS-20-G 1"-wd	
420	25	G 3/4"	M 36 x 2	58,0	16,0	32	46	EGE-DKOS-25-G 3/4"-wd	
420	25	G 1"	M 36 x 2	48,0	18,0	41	46	EGE-DKOS-25-G 1"-wd	
420	30	G 1"	M 42 x 2	46,0	18,0	41	50	EGE-DKOS-30-G 1"-wd	
420	30	G 1 1/4"	M 42 x 2	51,0	20,0	50	50	EGE-DKOS-30-G 1 1/4"-wd	
420	38	G 1 1/2"	M 52 x 2	60,0	22,0	55	60	EGE-DKOS-38-G 1 1/2"-wd	